

# PARTS LIST

## SERVICE TOOLS

LIT NO: L720

DATE: September 2018

REVISION: C

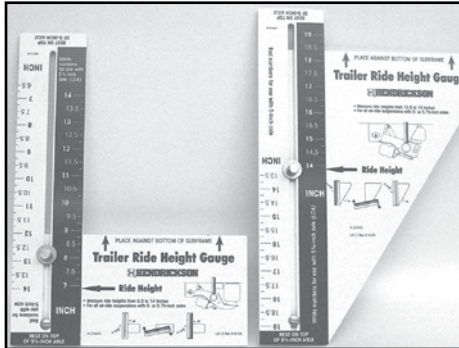

### RIDE HEIGHT GAUGE

#### Part No. A-23442

Used to measure ride heights from 13.5" to 19" on any Hendrickson top-mount suspension with 5" or LDA™ Large Diameter Axle.

#### Part No. A-23445

Used to measure ride heights from 6.5" to 14" on any Hendrickson low-ride suspension with 5" or LDA Large Diameter Axle.

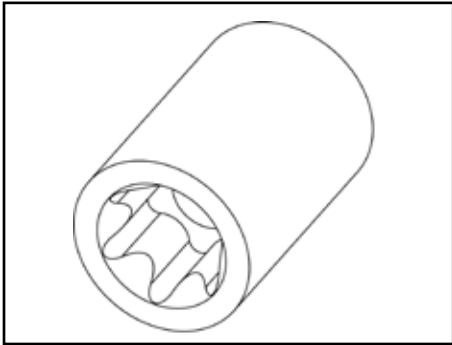

### E-20 SOCKET

#### Part No. S-24303 (3/4" drive)

#### S-24536 (1" drive)

#### S-25119 (1" drive with sleeve)

Used for the QUIK-ALIGN® pivot connection to install the shear-type bolt through the collars.

Used to install the lower shock mount on INTRAAX®, VANTRAAX® and HT™ SERIES HT250US models.

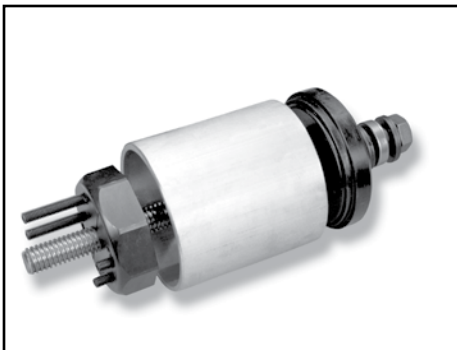

### TRI-FUNCTIONAL® BUSHING TOOL

#### Part No. S-21307 (TRI-FUNCTIONAL Bushing I & II – 6.75" wide)

#### S-24736 (TRI-FUNCTIONAL Bushing III – 3.625" wide)

Used to remove and replace TRI-FUNCTIONAL Bushings.



### TRI-FUNCTIONAL® BUSHING TOOL LUBE

#### Part No. S-21337 (extreme pressure lube)

Used on hex-head bolt, thrust bearing and thrust washers of the TRI-FUNCTIONAL Bushing Tool.

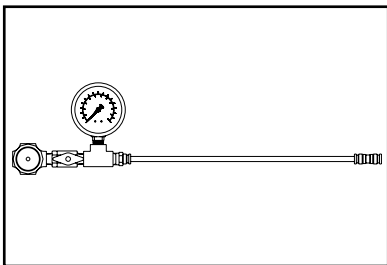

**TIREMAAX® EC PRESSURE TESTER**  
**Part No. VS-28707**

Provides a continuous regulated source of pressure to the system to check air fittings for leaks.

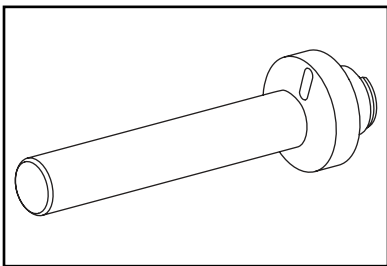

**TIREMAAX PLUG DRIVER**

- Part No. S-28146-1** (HN, 1.75" driver)
- S-28146-2** (HP, 2.50" driver)
- S-28146-3** (HP and HUS/P90, 2.75" driver)
- S-27399** (driver handle)

Used to insert spindle plugs to the proper depth.

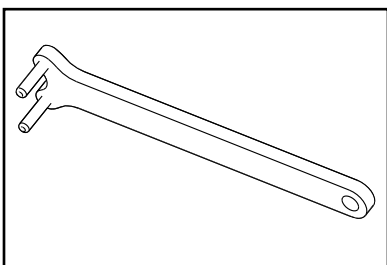

**TIREMAAX SPANNER WRENCH**

**Part No. S-29430**

Holds rotary union stationary while tightening threaded axle hose.

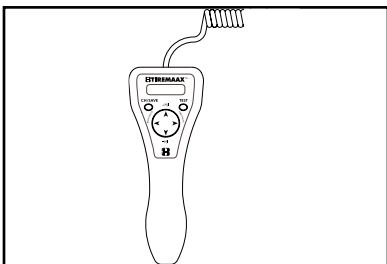

**TIREMAAX HAND PROGRAMMER**

**Part No. VS-28321**

Used to reset TIREMAAX target tire pressure setting and to test ECU solenoid valve.

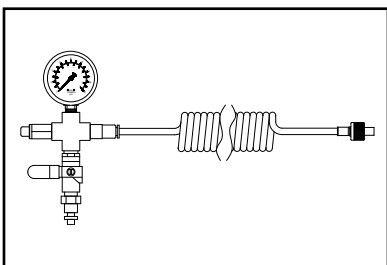

**TIREMAAX PRO TARGET GAUGE**

**Part No. VS-32331**

Provides a convenient way to check the controller delivery pressure without disconnecting any of the delivery line fittings. The flexible tube stretches to allow the gauge to be visible from the controller location while adjusting target pressure.

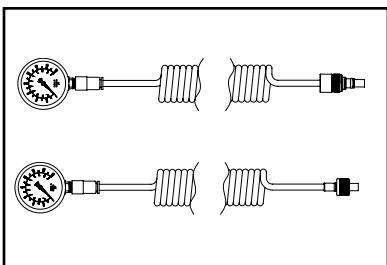

**TIREMAAX CP TARGET GAUGE**

- Part No. VS-32344** (CP with Hubcap-Mounted Rotary Union)
- VS-30468** (CP with Spindle-Mounted Rotary Union)

Provides a convenient way to check the controller delivery pressure without disconnecting any of the delivery line fittings. The flexible tube stretches to allow the gauge to be visible from the controller location while adjusting target pressure.

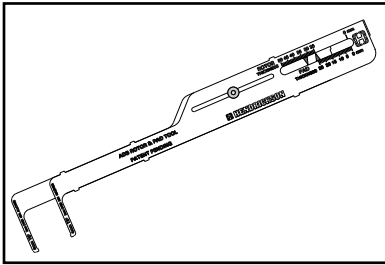
**AIR DISC BRAKE WEAR TOOL****Part No. S-37430**

Used to measure rotor and pad thickness on all air disc brake systems.

**AIR DISC BRAKE BASIC TOOL****Part No. S-32676-5**

Used for air disc brake maintenance of WABCO PAN22 and Hendrickson MAXX22T™ systems.

**HENDRICKSON MAXX22T™ TOOL****Part No. S-35303-6**

Used to remove and install brake components for Hendrickson MAXX22T systems.

**WABCO PAN22 TOOL****Part No. S-32676-6**

Used to remove and install brake components for WABCO PAN22 air disc brake systems.

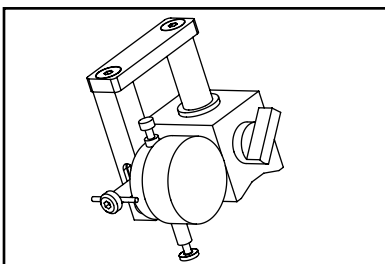
**END PLAY GAUGE****Part No. S-36710-1 (HN)****S-36710-2 (HP)****S-36710-3 (HN & HP)****S-36706 (digital indicator)**

Used to measure end play for all air disc brake systems.

Call Hendrickson at **330.489.0045** or **866.RIDEAIR (743.3247)** for additional information.



[www.hendrickson-intl.com](http://www.hendrickson-intl.com)

**TRAILER COMMERCIAL VEHICLE SYSTEMS**

2070 Industrial Place SE  
Canton, OH 44707-2641 USA  
866.RIDEAIR (743.3247)  
330.489.0045 • Fax 800.696.4416

**Hendrickson Canada**

250 Chrysler Drive, Unit #3  
Brampton, ON Canada L6S 6B6  
800.668.5360  
905.789.1030 • Fax 905.789.1033

**Hendrickson Mexicana**

Circuito El Marqués Sur #29  
Parque Industrial El Marqués  
Pob. El Colorado, Municipio El Marqués,  
Querétaro, México C.P. 76246  
+52 (442) 296.3600 • Fax +52 (442) 296.3601